

General Notes:

1. This drawing to be read in conjunction with all relevant architects and engineers drawings and specifications.
2. All dimensions must be checked and approved by the main contractor.
3. Any changes in loadings should be discussed with Creagh Concrete limited.
4. Units should not be cut without discussing with Creagh Concrete Ltd. technical department.
5. No variation to the details shown is permitted without prior confirmation by Creagh Concrete.
6. Bearing surfaces for Creagh units must be level.

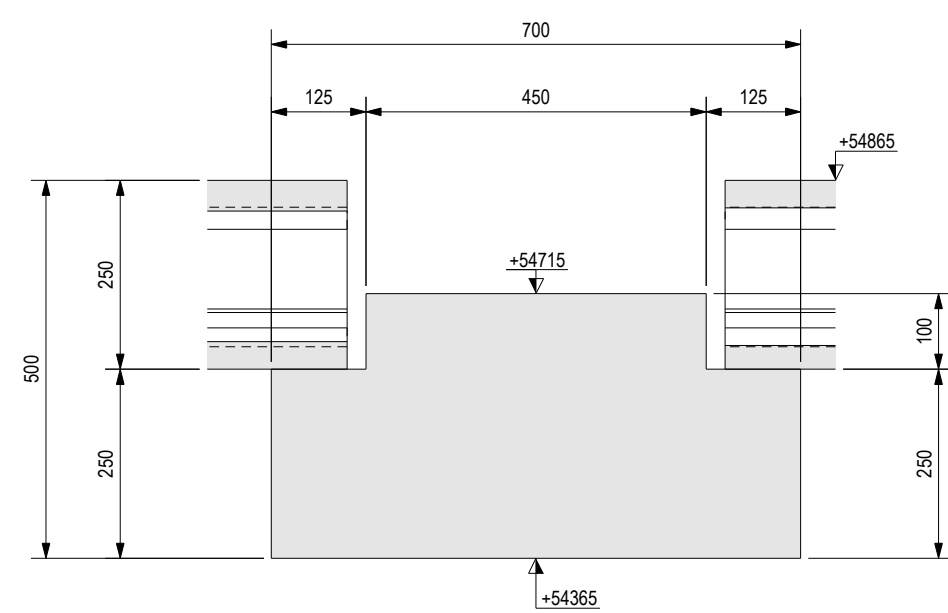

1 - 1:1:10
402

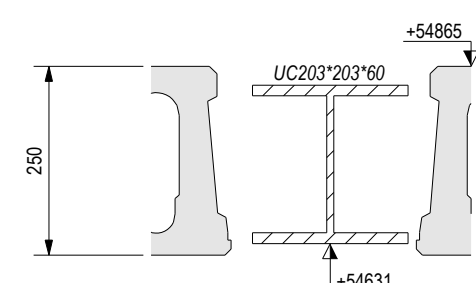

2 - 2:1:10
402

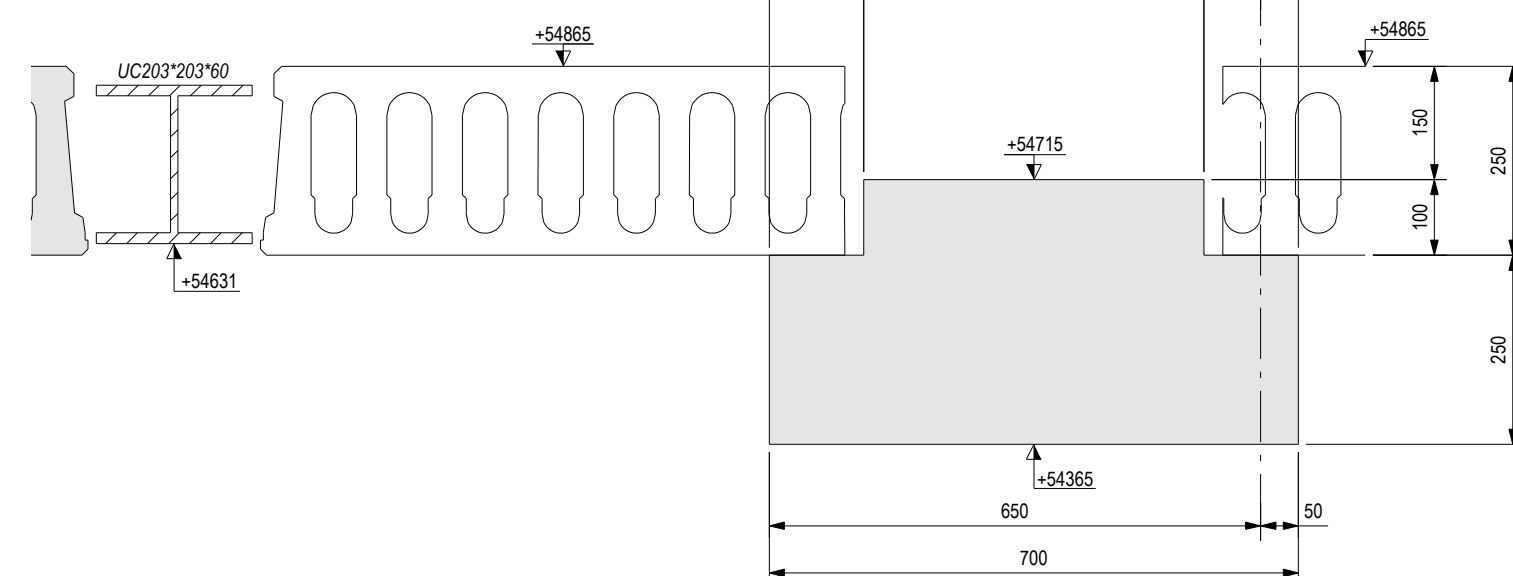

3 - 3:1:10
402

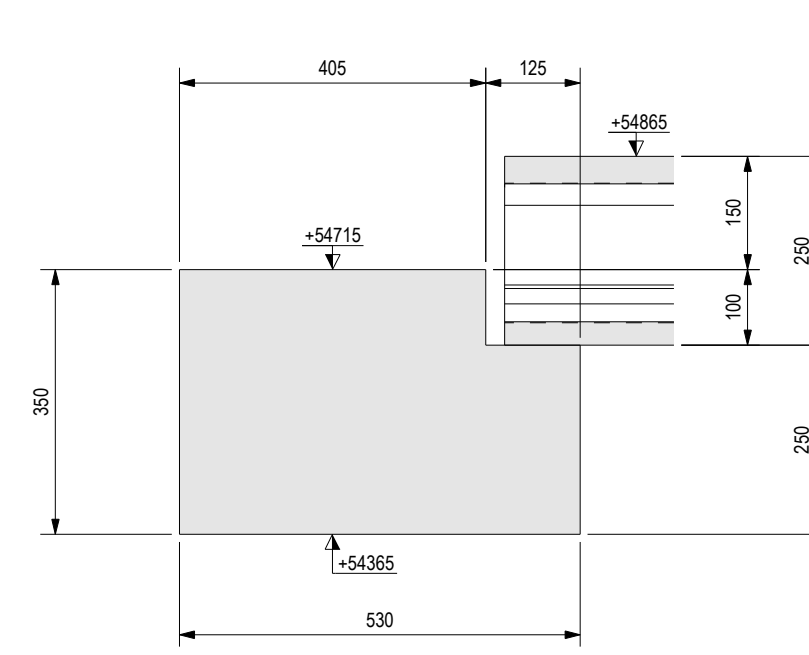

4 - 4:1:10
402

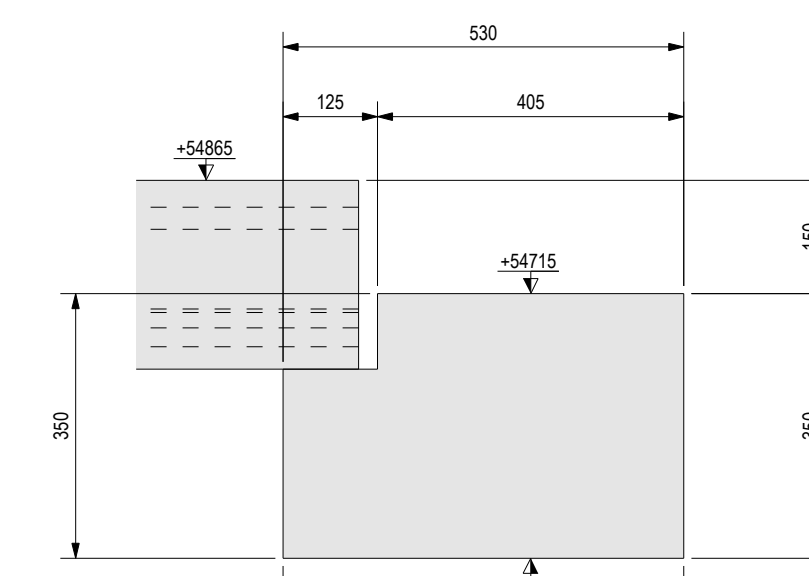

5 - 5:1:10
402

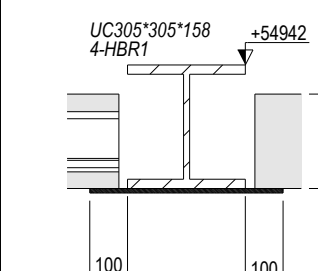

32 - 32:1:20
402

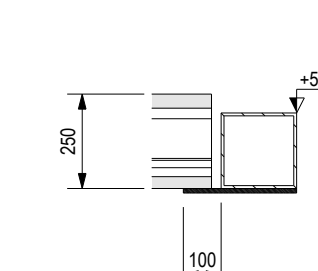

33 - 33:1:20
402

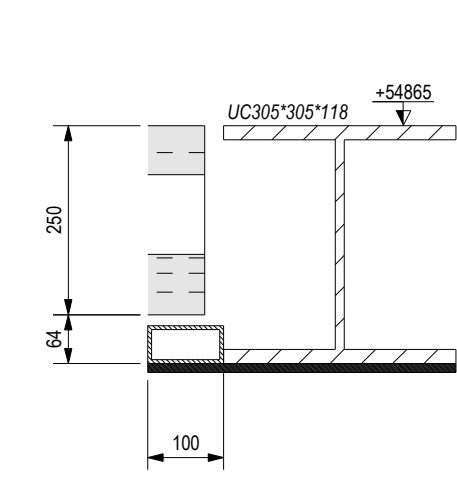

6 - 6:1:10
402

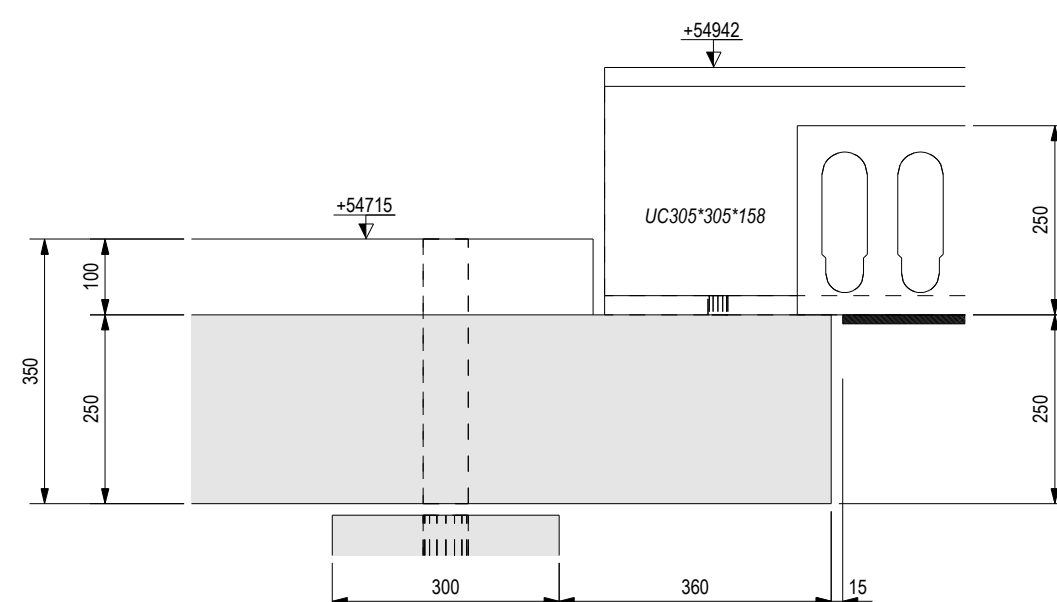

7 - 7:1:10
402

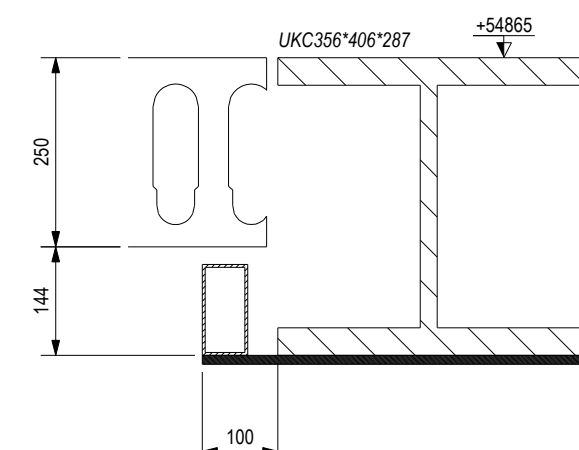

8 - 8:1:10
402

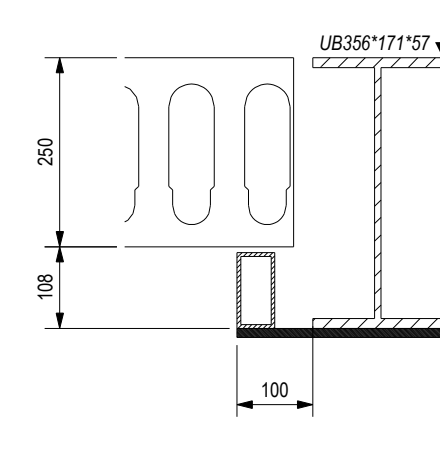

9 - 9:1:10
402

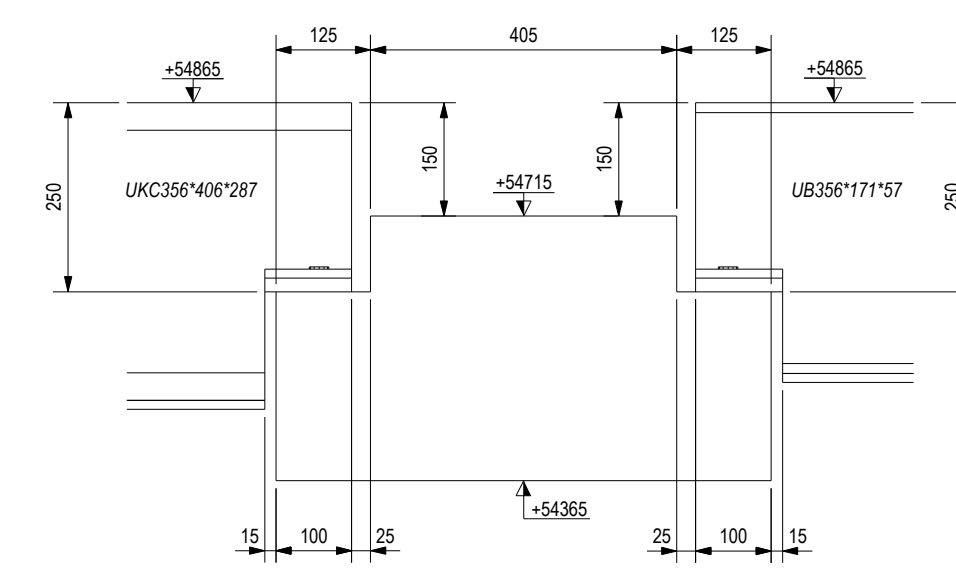

10 - 10:1:10
402

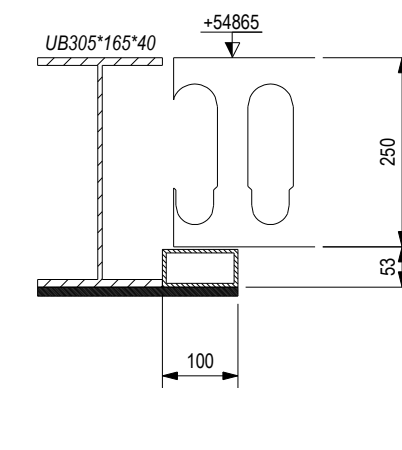

11 - 11:1:10
402

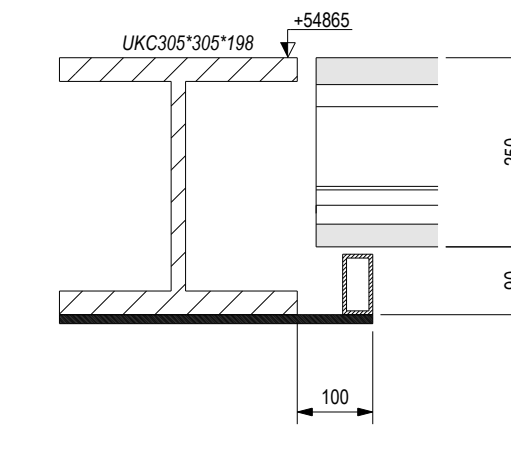

5 - 5:1:10
402

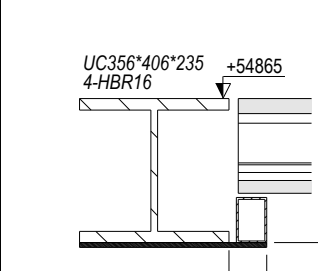

34 - 34:1:20
402

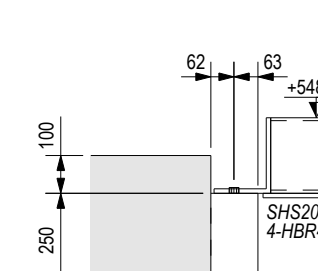

35 - 35:1:20
402

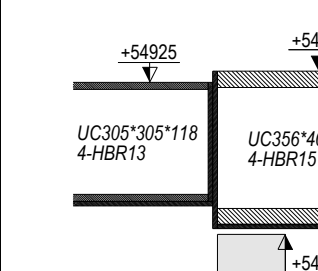

36 - 36:1:20
402

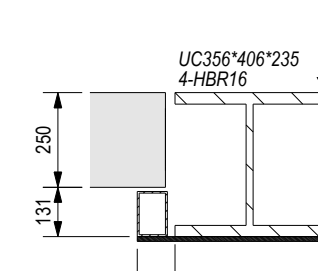

37 - 37:1:20
402

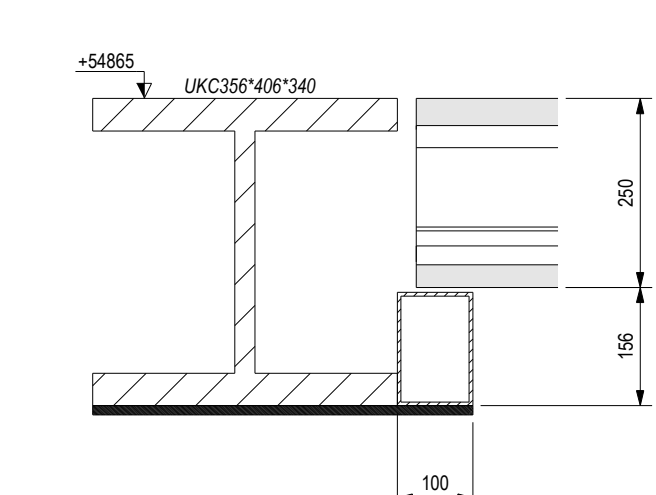

13 - 13:1:10
402

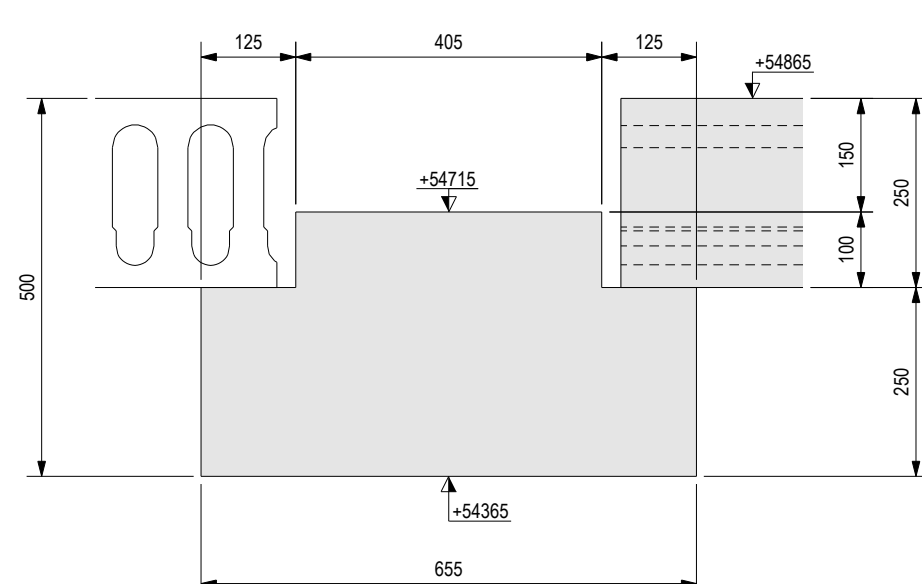

14 - 14:1:10
402

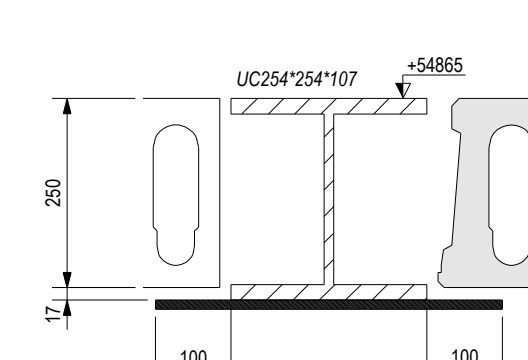

15 - 15:1:10
402

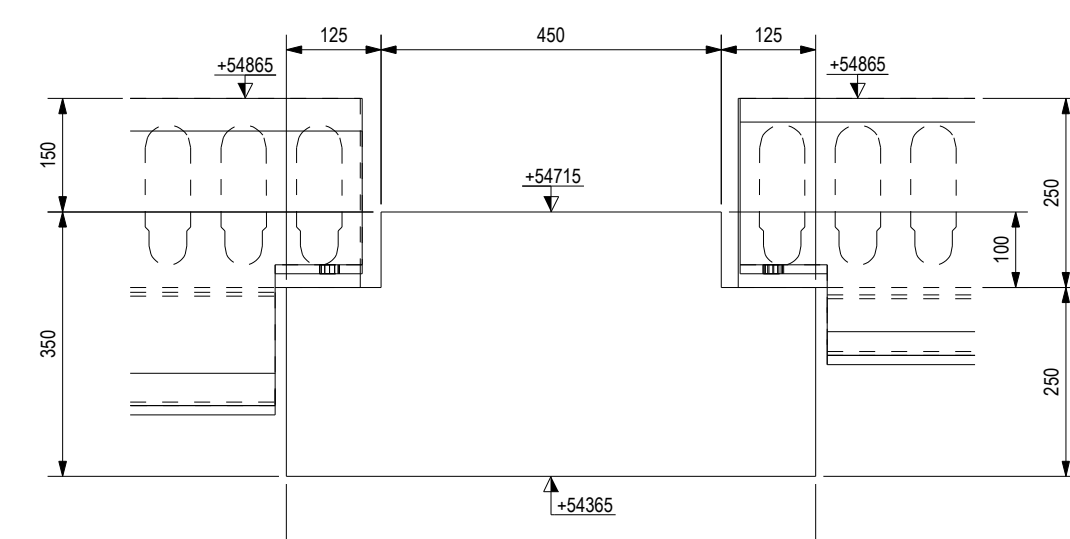

16 - 16:1:10
402

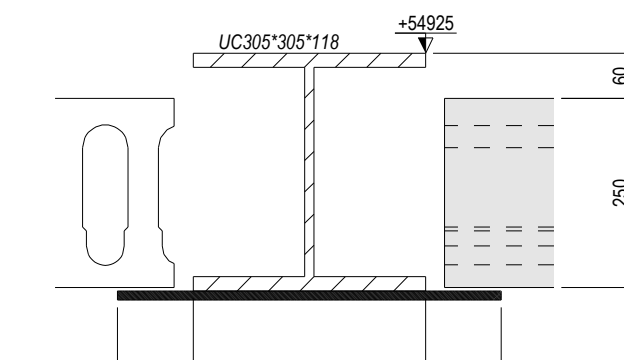

18 - 18:1:10
402

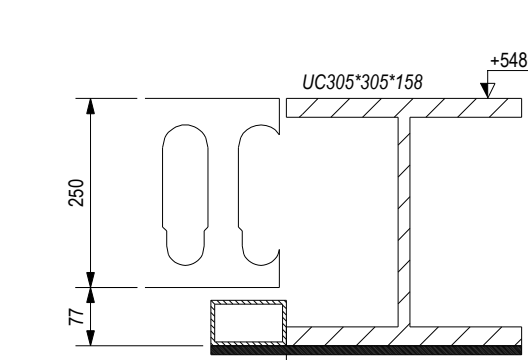

19 - 19:1:10
402

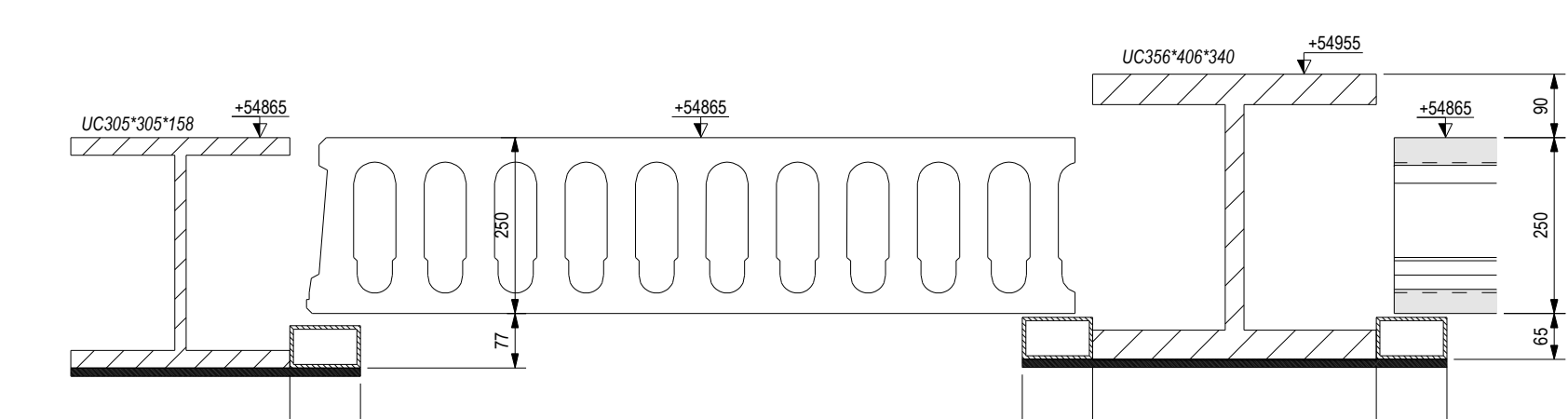

20 - 20:1:10
402

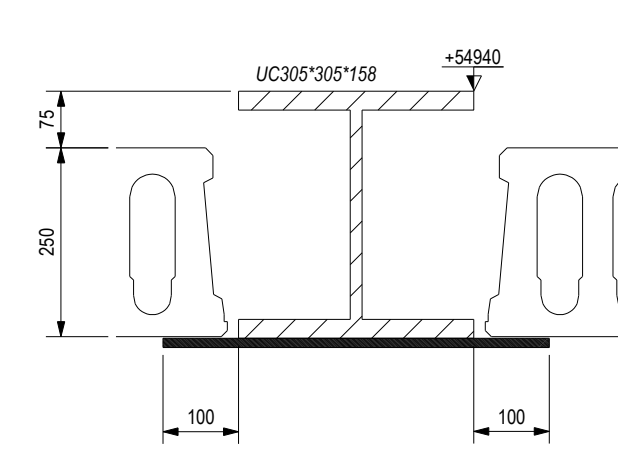

21 - 21:1:10
402

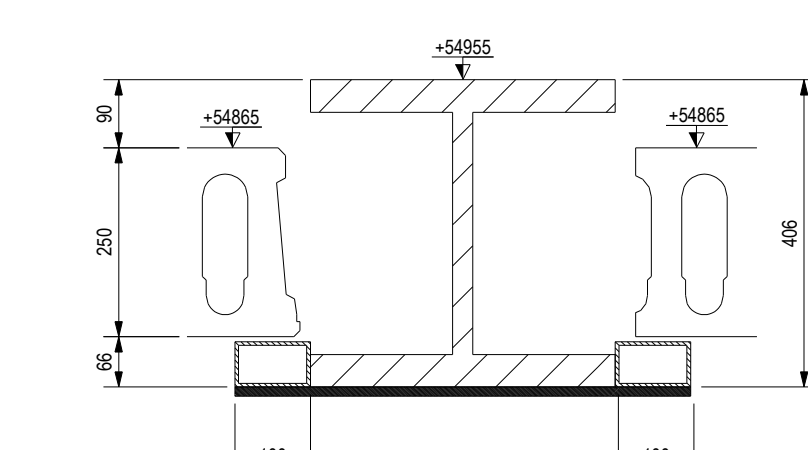

22 - 22:1:10
402

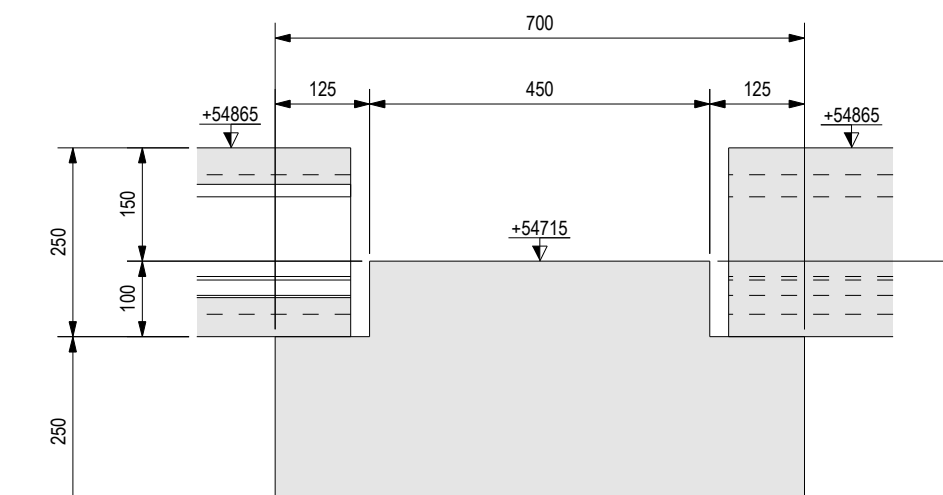

23 - 23:1:10
402

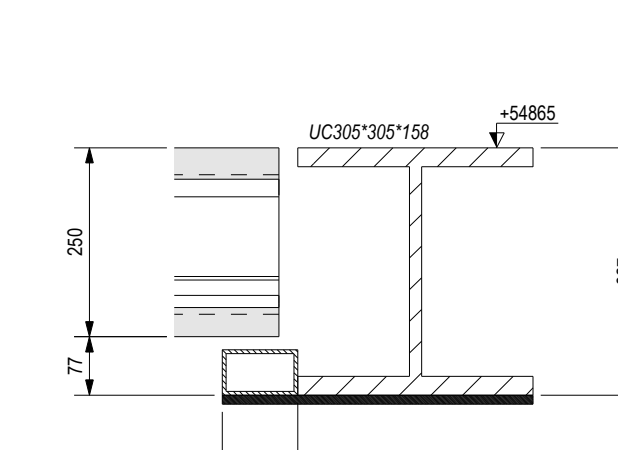

24 - 24:1:10
402

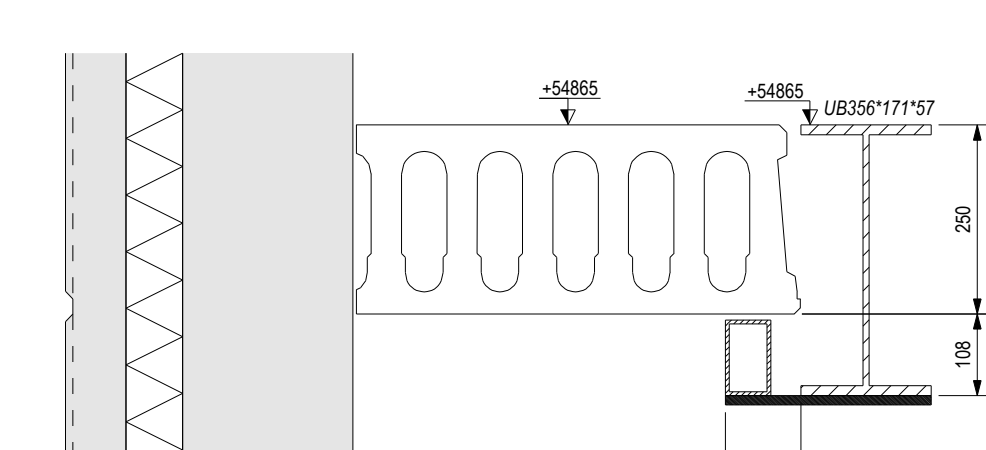

25 - 25:1:10
402

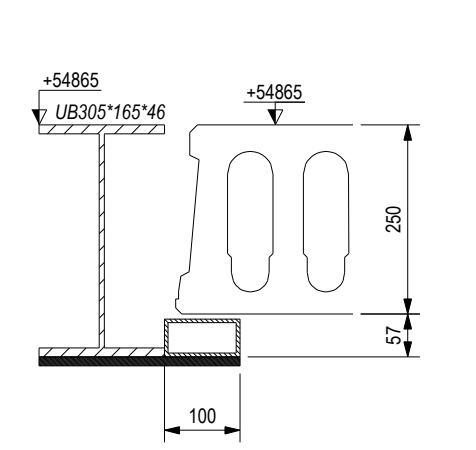

26 - 26:1:10
402

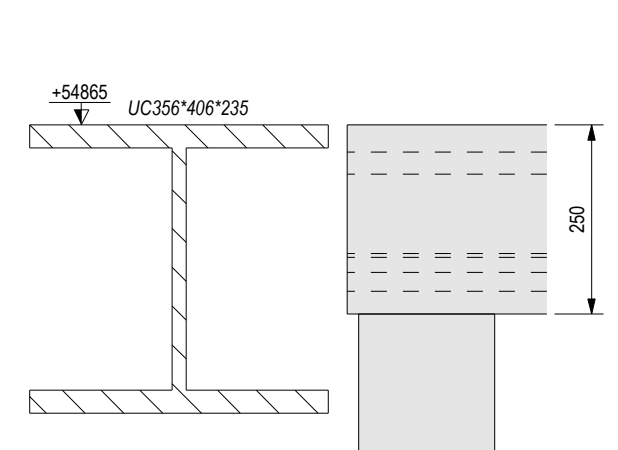

27 - 27:1:10
402

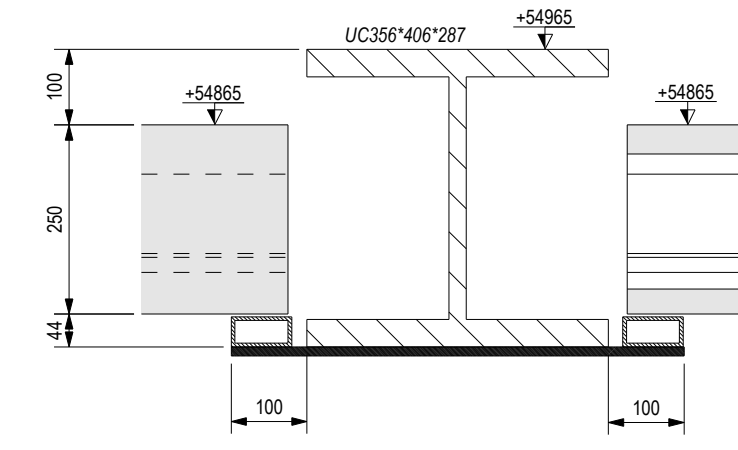

28 - 28:1:10
402

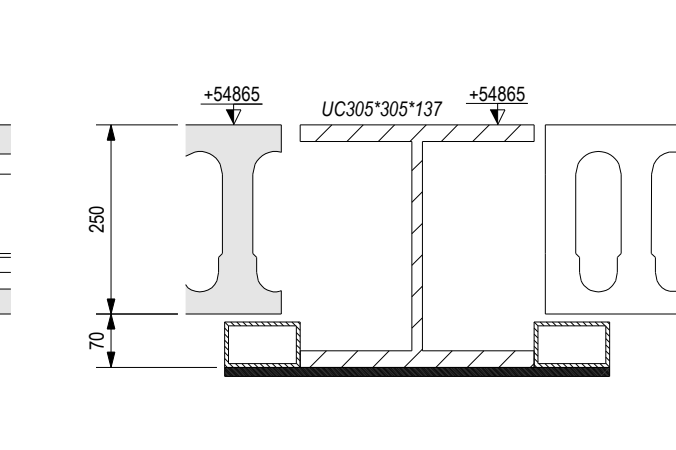

29 - 29:1:10
402

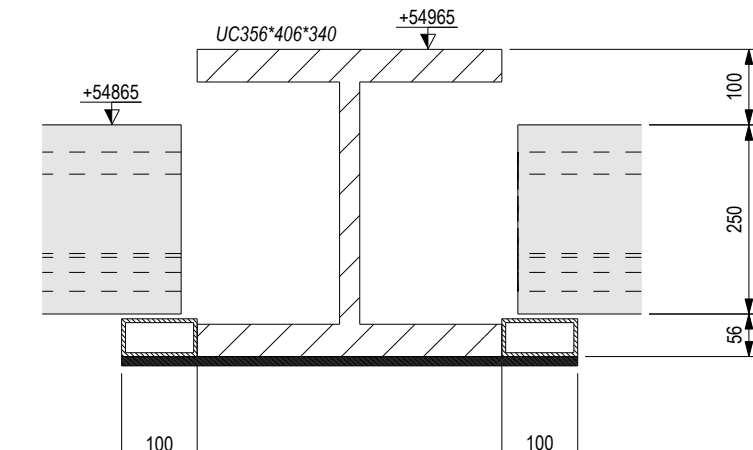

30 - 30:1:10
402

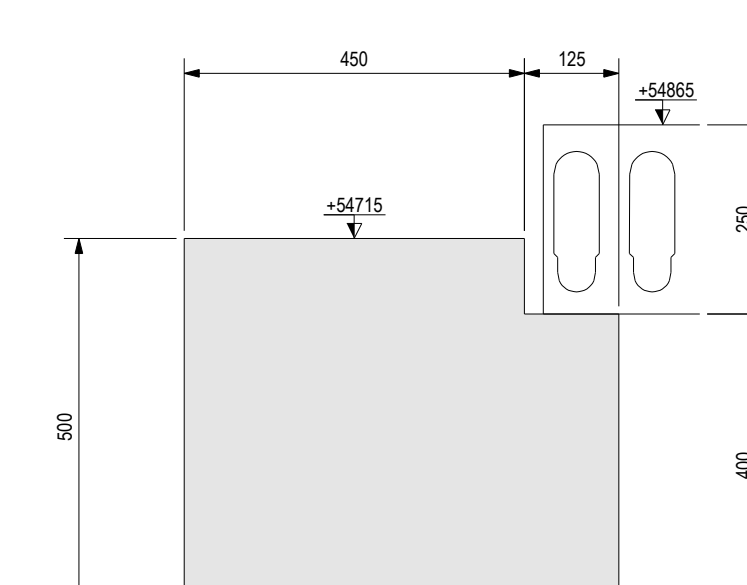

31 - 31:1:10
402

C5	25.07.11	MD	SK	SECTIONS 4-4 & 5-5 AMENDED
C4	20.07.11	MD	SK	SECTIONS 35-35, 36-36, 37-37 ADDED
C3	19.07.11	MD	SK	18-18 & 21-21 AMENDED
C2	18.07.11	MD	SK	7-7, 30-30, 32-32 AMENDED
C1	18.07.11	MD	SK	ISSUED FOR CONSTRUCTION

Rev.	DATE	MADE BY	CHECKED BY	REVISION NOTES
------	------	---------	------------	----------------

CREAGH
CONCRETE PRODUCTS LTD
Blackpark Rd, Tomerbridge,
Co. Antrim, N. Ireland, BT14 3SE
Tel: 028 79650500 Fax: 028 79650804

CONTRACTOR	PHIL UK				
CONTRACT	COWES ONE PATHFINDER ISLE OF WIGHT				
TITLE	PHASE 4 ROOF LEVEL SECTIONS				
DRAWN BY:	MD	CHECKED BY:	SCH	INSPECTED BY:	SK
DATE:	06.07.11	DATE:	06.07.11	DATE:	06.07.11
BASE SCALE:	1:25	ISSUE STATUS:	CONSTRUCTION		

CONTRACT No.	11-0141	DWG No.	423	REV.	C5
--------------	---------	---------	-----	------	----